



ATEX Compression Load Cell DLA

Robust digital ATEX certified compression load cell produced in stainless steel and hermetically sealed to IP68 for hygienic weighing installations, installations in tough environments and general process weighing. The DLA compression load cell can be used in ATEX (Ex) and non-ATEX applications

Type:	DLA (ATEX) DL (Non-ATEX)
Capacity (Emax):	50, 100, 150, 250, 500, 1000, 1500, 2000, 3000, 4000, 5000kg
Accuracy:	Industrial 0.10%, Precision 0.05%, High Precision 0.025%
Overload Tolerance:	Up to 500% of rated capacity

- Made in Denmark
- Robust capacitive technology
- High tolerance of up to 1.000% overload
- Electropolished stainless steel 1.4542 (17-4 PH)
- Hermetically sealed to IP68
- Laser welded with Duplex 1.4462 stainless steel
- ATEX version available (Zone 1, 2, 21, 22)
- Low profile and hygienic design
- Can be supplied with Mud resistant and Halogen free cables for offshore installation

- High Accuracy, High resolution
- Withstands welding voltages and ESD
- Cable length up to 100meters
- Capacity (Emax): 50, 100, 150, 250, 500, 1000, 1500, 2000, 3000, 4000, 5000kg
- Accuracy: Industrial 0.10%, Precision 0.05%, High Precision 0.025%
- Load cell cable replaceable
- Calibration independent of cable length
- Easy mechanical and electrical installation
- Can be used in both ATEX and non-ATEX installations

- [Digital Compression Load Cell Type DL Dimension PDF](#)
- [4000 Generation ATEX Certificate SEV07 ATEX 0150 \(GERMAN\) PDF](#)
- [4000 Generation ATEX Certificate SEV07 ATEX 0150 \(ENGLISH\) PDF](#)
- [DL DLA Compression Load Cell STEP 3D CAD File \(right click -> "Save Link As..."\)](#)
- [DL DLA with Base Plate JPG](#)
- [MD DL DLA Base Plate JPG](#)
- [MD DL DLA Base Plate PDF](#)
- [MD DL DLA Base Plate STEP \(right click -> "Save Link As..."\)](#)
- [Guideline Correct Mounting of BNC Connector \(UK\) PDF](#)
- [VIDEO - Correct Mounting of BNC Connector](#)

Digital Compression Load Cell – Type DL

Dimensions (mm)

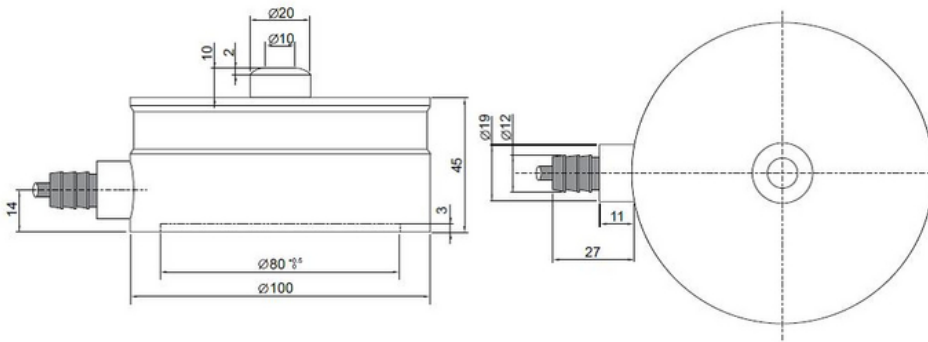

Parameter	Unit	0.10%	0.05%	0.025%
Rated capacity (E_{max})	kg	50, 100, 150, 250, 500, 1000, 1500, 2000, 3000, 4000, 5000		
Safe overload limit	% of E_{max}	200 to 500		
Safe sideload limit	% of E_{max}	300 to 1000		
Minimum dead load	% of E_{max}	0		
Accuracy	% of E_{max}	0.100	0.050	0.025
Repeatability	% of E_{max}	0.030	0.025	0.020
Hysteresis	% of E_{max}	0.055	0.040	0.020
Creep 30 min.	% of E_{max}	0.060	0.040	0.040
Temperature effect on zero	% /10°C	0.060	0.055	0.055
Temperature effect on sensitivity	% /10°C	0.060	0.055	0.055
Compensated temperature range	°C	-10 to 50		
Operating temperature range	°C	-50 to 70 (100*)		
Deflection at E_{max}	mm	0.10		
Measuring rate	Hz	500		
Supply	Vdc	24Vdc ±5%		
Internal resolution	Bit	24		
Material		Stainless Steel 17-4 PH and AISI 316		
Protection		IP68		
Cable		6meter standard coaxial RG-58 (Ø6mm) with BNC connector		
Maximum cable length	m	100		
Weight	kg	2.0		
Output options		EtherNet/IP, PROFINET, EtherCAT, Profibus DP, Modbus TCP/IP, DeviceNet, RS485, 4-20mA, 0-10Vdc		

* with Teflon cable

- Tank weighing
- Process weighing
- Big-bag equipment
- Filling and dosing
- Offshore
- Level measurement
- Platform scales
- Hopper scales
- Heavy duty applications
- Belt scales

- ATEX (Zone 1, 2, 21, 22) version type DLA
- ATEX II 2G Ex ia IIC T6 / ATEX II 2D Ex iaD 21 T85°C
- Base plate available
- Load cell cable length 10, 20, 50 or 100meters
- Mud resistant and Halogen free cables for offshore installation
- Special PE load cell cable available for freezing low temperature (can be used down to -50 degrees Celsius)
- Special Teflon load cell cable available for very high temperature (can be used up to 100 degrees Celsius)