

Fixed end:

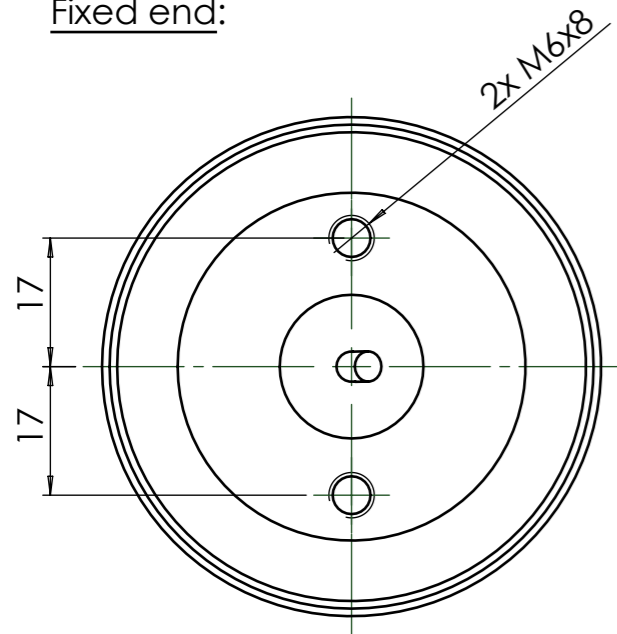

Moving end:

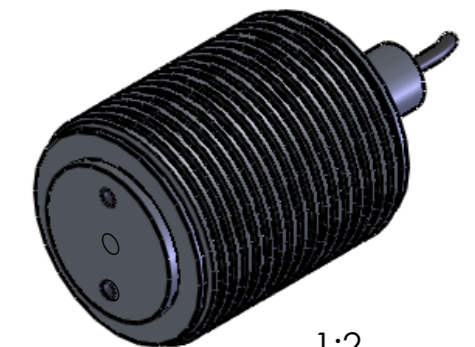
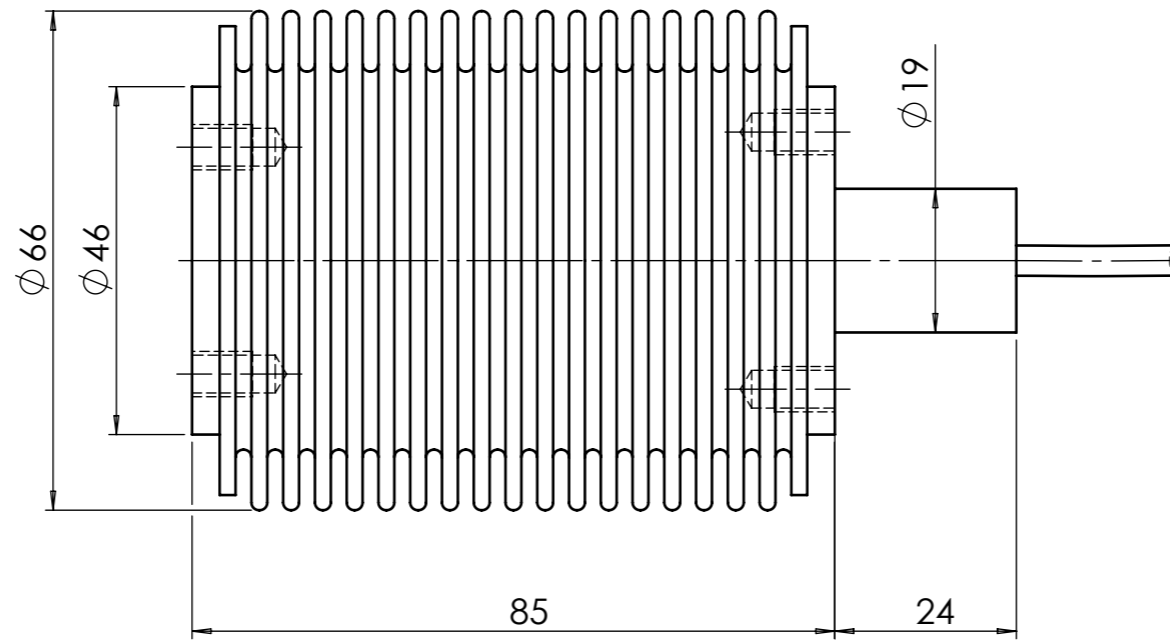
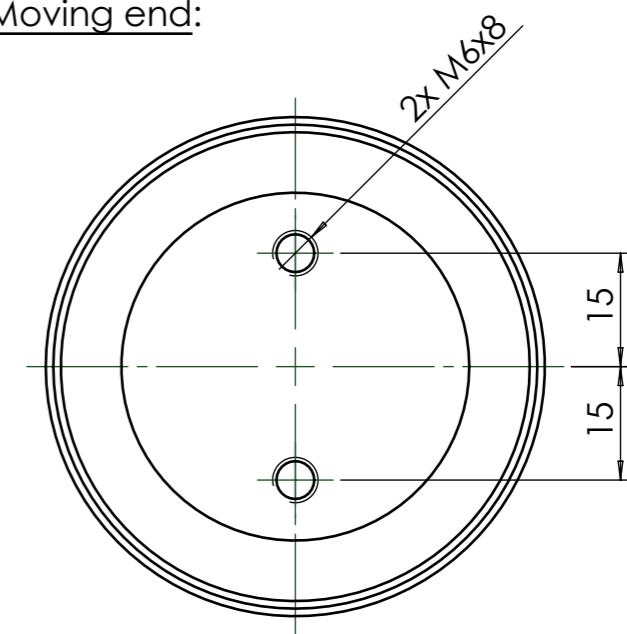

1:2

-All dimensions in mm

Description:		Beam Load Cell type SBL		Drawing no.:	LC-DIG\SBL	Part rev.:	0	Drawing rev.:	0
Sign.:	TTP	Drawn date:	23-03-2007	Scale:	1:1	A3			
Rev. sign:	TTP	Rev. date:	13-04-2007						
Material:	AISI 316 / 17-4 PH								
Approved by:	TU/FJE	Appr. date:	23-03-2007						
<small>Dimension without tolerance, follows DS/ISO 2768-m This drawing is the property of Eilersen, and is not to be copied or shown to third parties.</small>									