

Fixed end:

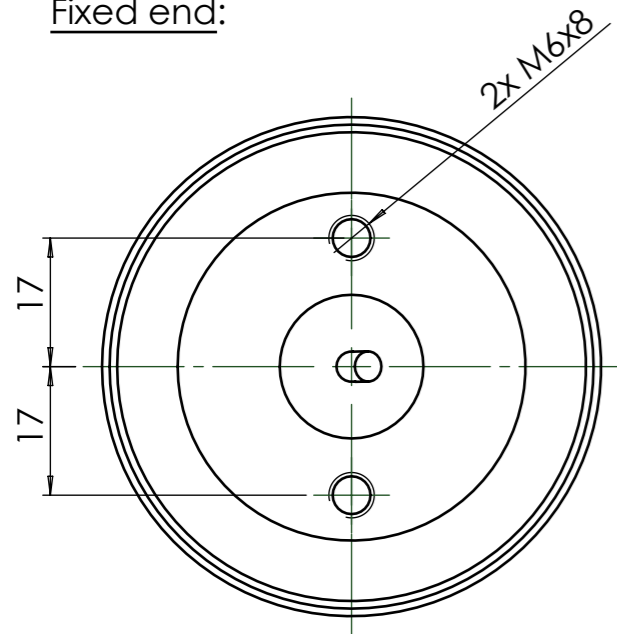

Moving end:

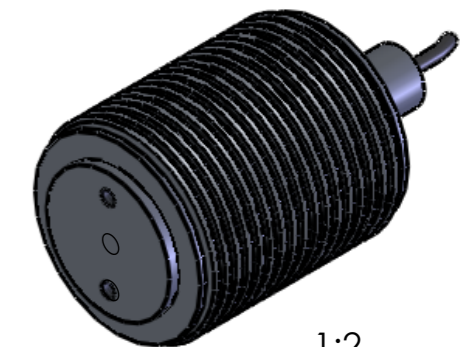
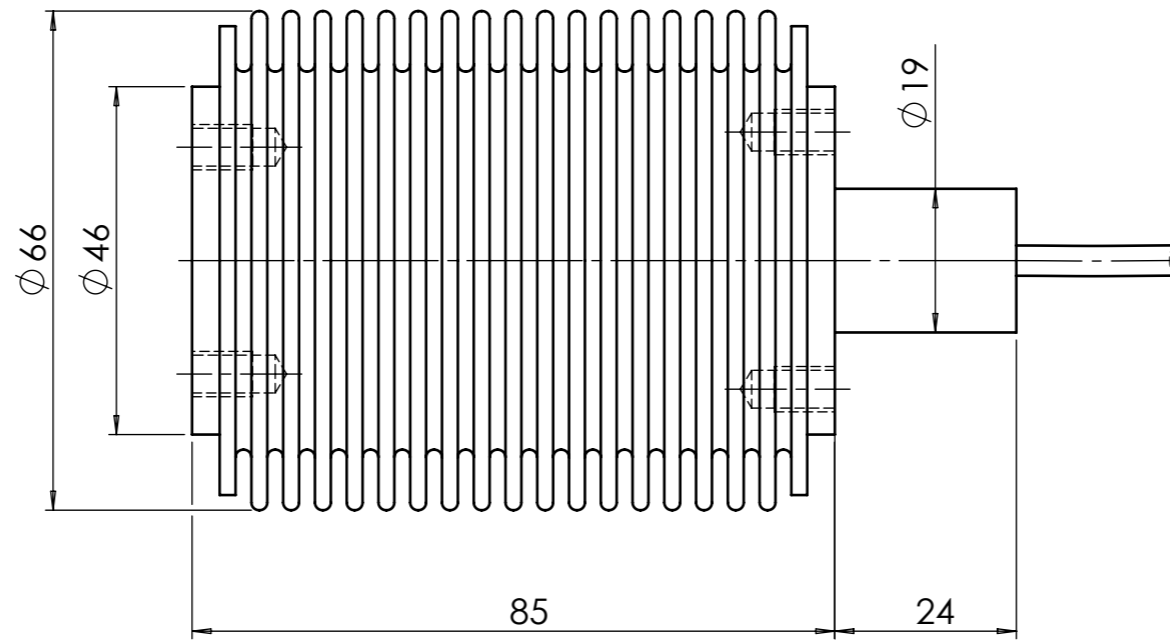
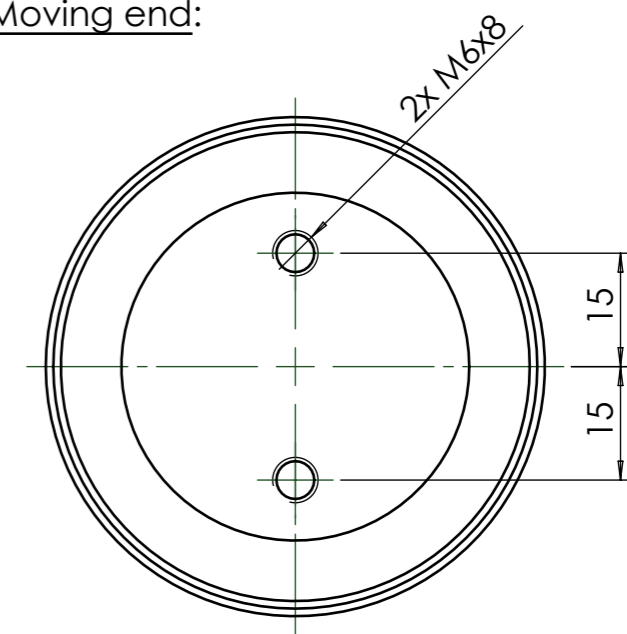

1:2

**-All dimensions in mm**

|  |        |             |                   |        |            |               |
|--|--------|-------------|-------------------|--------|------------|---------------|
| Description:   |        |             | Drawing no.:      |        | Part rev.: | Drawing rev.: |
| <b>Beam Load Cell type SDC</b>   |        |             | <b>LC-DIG\SDC</b> |        | 0          | 0             |
| Sign.:   | TTP    | Drawn date: | 23-03-2007        | Scale: | 1:1        | A3            |
| Rev. sign:   | TTP    | Rev. date:  | 13-04-2007        |        |            |               |
| Material:  |        |             |                   |        |            |               |
| <b>AISI 316 / 17-4 PH</b>  |        |             |                   |        |            |               |
| Approved by:   | TU/FJE | Appr. date: | 23-03-2007        |        |            |               |
| Dimension without tolerance, follows DS/ISO 2768-m<br>This drawing is the property of Eilersen, and is not to be copied or shown to third parties. |        |             |                   |        |            |               |

**Eilersen**  
Industrial Sensors